

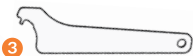

Camera Clamp Plus

User Manual

1 Package Contents

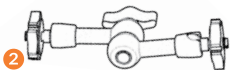
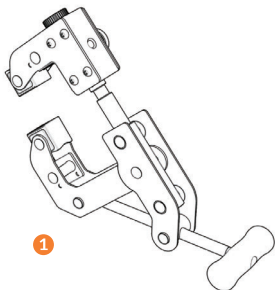

1. Camera Clamp
2. Magic Arm
3. Wrench
4. Main Extension Pole
5. Threaded Extension Pole

2 Device Parts

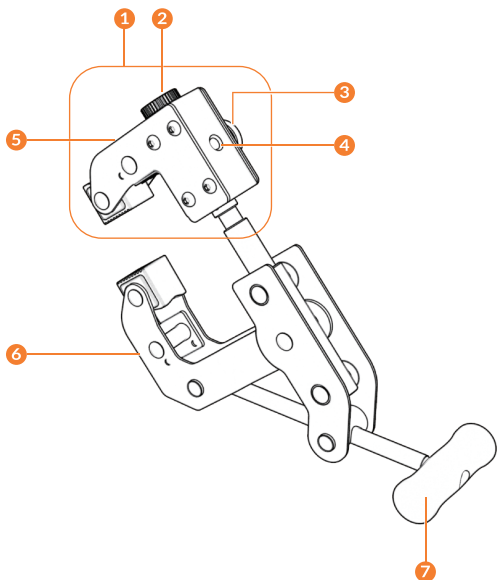

CLAMP

1. Clamp Head
2. Extension Pole Hole Knob
3. Clamp Head Knob
- 4~6. Mounting Hole (1/4")
7. Handle

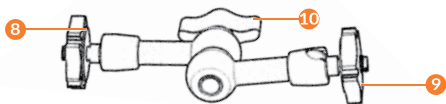

MAGIC ARM

8~9. Mounting Platform (1/4")

10. Flex Arm Knob



MAIN EXTENSION POLE

11. Tightening Knob

12. Tube Adapter

3 Assembling

1

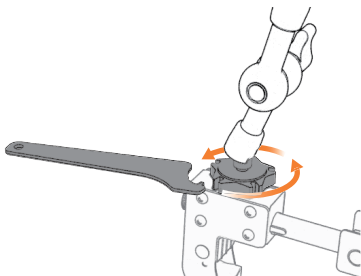

Mount the magic arm onto clamp.
Use wrench to secure the magic arm.

2

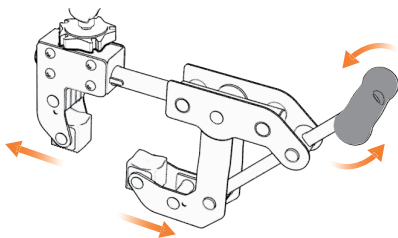

Swivel the handle to release the clamp.

3

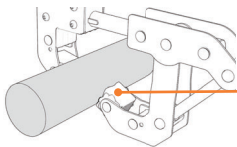

**Irregular
cushion
(for tube
shape object)**

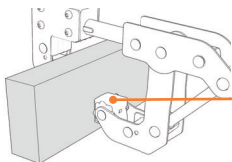

**Grooved
cushion
(for cube
shape object)**

Mount the clamp. Tighten it.
Clamping range: 0.04~3.5in (1~90mm)

4

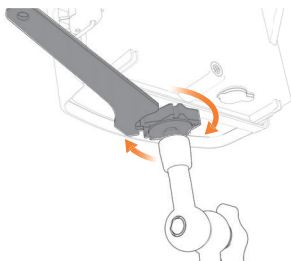

Mount the camera onto the mounting platform.
Use wrench to secure the camera.

5

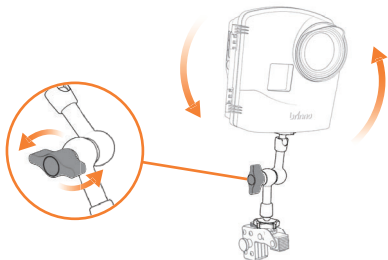

Turn the flex arm knob to adjust the shooting angle.
Tighten it.

Better grasp for flat surface under 2.4 in (60 mm)

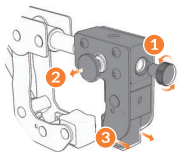

Pull clamp head knob.

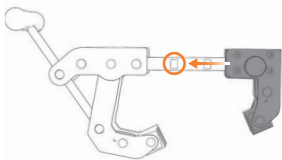

Slide clamp head down.

Mount the clamp.
Tighten it.

Clamping range:
0.04~2.4in (1~60mm)

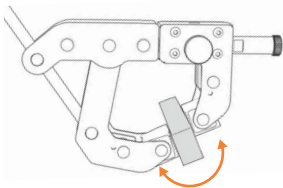

4 Extend Clamping Range

! Extension pole only works on flat surface.

1 Single Pole (3.5~7.1in) 90~270mm

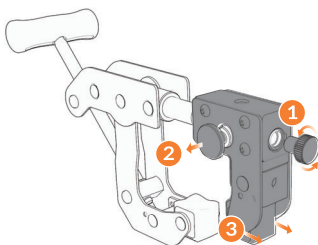

1. Loosen the extension pole hole knob.
2. Pull out the clamp head knob.
3. Take off the clamp head.

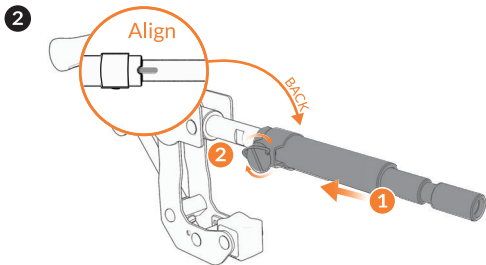

1. Slide the main extension pole. Align the groove to push two sections together.
2. Tighten the knob.

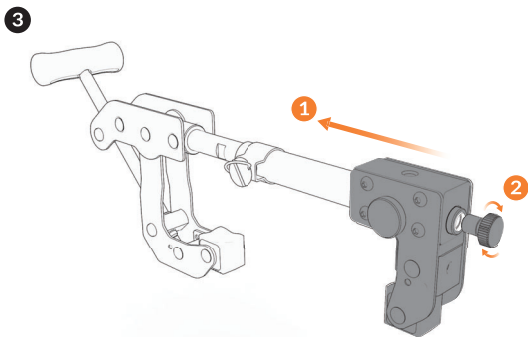

1. Put clamp head back on & slide it to the main extension pole.
2. Tighten the extension pole hole knob.

Clamping range (for flat surface)

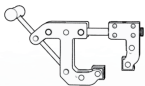

0.04 ~ 3.5 in
(1 ~ 90 mm)

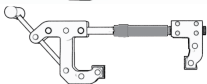

3.5 ~ 7.1 in
(90 ~ 180 mm)

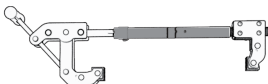

7.1 ~ 10.6 in
(180 ~ 270 mm)

5 Multiple Extension Poles

1

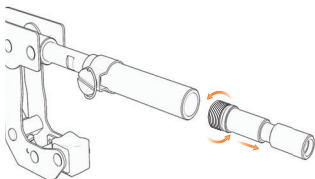

Remove the tube adapter.

2

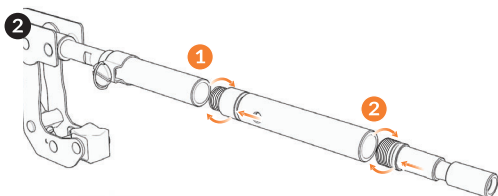

1. Assemble threaded extension pole onto the main extension pole.
2. Install tube adapter to the other side of threaded extension pole.

3

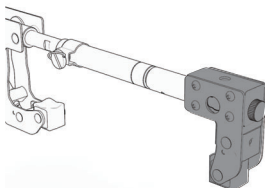

Install the clamping head.

6 Specifications

Model No.	ACC1000P
Contents	Camera clamp; Magic arm; Extension poles; Wrench
Camera Mount Screw	1/4"
Clamping Range	Tube: 0.4~ 3.5 in (10 ~ 90 mm) Flat surface: 0.04~ 3.5 in (1 ~90 mm) 3.5~ 10.6 in (90 ~270 mm) (with extension pole)
Magic Arm Load Capacity	6.6 lb (3 kg)
Clamp Load Capacity	110 lb (50 kg) (without extension pole)
Size (LxWxH)	Folded: 8.2x 3.7x 1.5 in (209x 94x 39 mm) Extended: 6.9x 7.1x 2.4 in (176x 180x 60 mm)
Weight	2.3lb (1.05 kg)
Materials	Clamp: Stainless; Aluminum alloy Magic arm: Stainless; Aluminum alloy Extension pole & wrench: Stainless



For manuals in other languages, visit
www.brinno.com/support

The product features, specifications sheets and instructions may differ from actual products. Please refer to Brinno official site for the latest version of user manual.

